

Remove the filter holder (1/4 turn forward) and insert the filter strainer (5). The filter strainer has markings for 2 and 4 cups. Pour in the coffee loosely and then clean coffee remains from the edge of the filter holder (6). Do not tamp the coffee; do not fill above the 4-cup marking.

filter strainer, filter basket for coffee, filter

filter strainer, filter basket for coffee, filter

Replace filter holder containing the filter and coffee. The filter holder must be placed so that the arrow on the filter is in line with the beginning of the white line on the unit. Press filter holder upwards and turn firmly to the right - at least to the "MIN" mark and at the farthest to the "MAX" mark (7).

filter holder

carafe lid, glass jug lid, jug lid, lid

Place the lid on the glass jug so that the lid opening faces the spout (8).

glass jug, carafe

glass jug, carafe

Place the glass jug underneath the filter holder and ensure that the outlet of the filter holder is facing the opening of the jug lid (9). If you wish to pour the espresso directly into the espresso cups, the cup adapter must be attached to the filter holder (10).

carafe lid, glass jug lid, jug lid, lid

Place the cups beneath the outlet openings of the adapter (11). In this case, the machine may only be filled with water for a maximum of 2 cups.

Before switching on the appliance, ensure that the steam outlet is closed. Switch on the appliance (12).

After approx. 2 minutes, the water boils and is forced through the ground coffee into the glass jug placed beneath it or into the cups.

glass jug, carafe

When the coffee making cycle is over, switch off the appliance.

Before removing the filter holder for cleaning, ensure that the boiler is no longer under pressure by opening the steam outlet as a check before opening the water container lid. When removing the filter holder, keep the filter strainer in the filter holder.

water container, boiler

cap for boiler container, water container lid, lid cover of the water container, lid of the boiler

When removing the filter holder, keep the filter strainer in the filter holder.
(When tapping out the coffee, the filter strainer can be held in place using the plastic marker).

Making Cappuccino (13)

This appliance can be used not only to make espresso coffee but also to foam the milk needed for cappuccino.

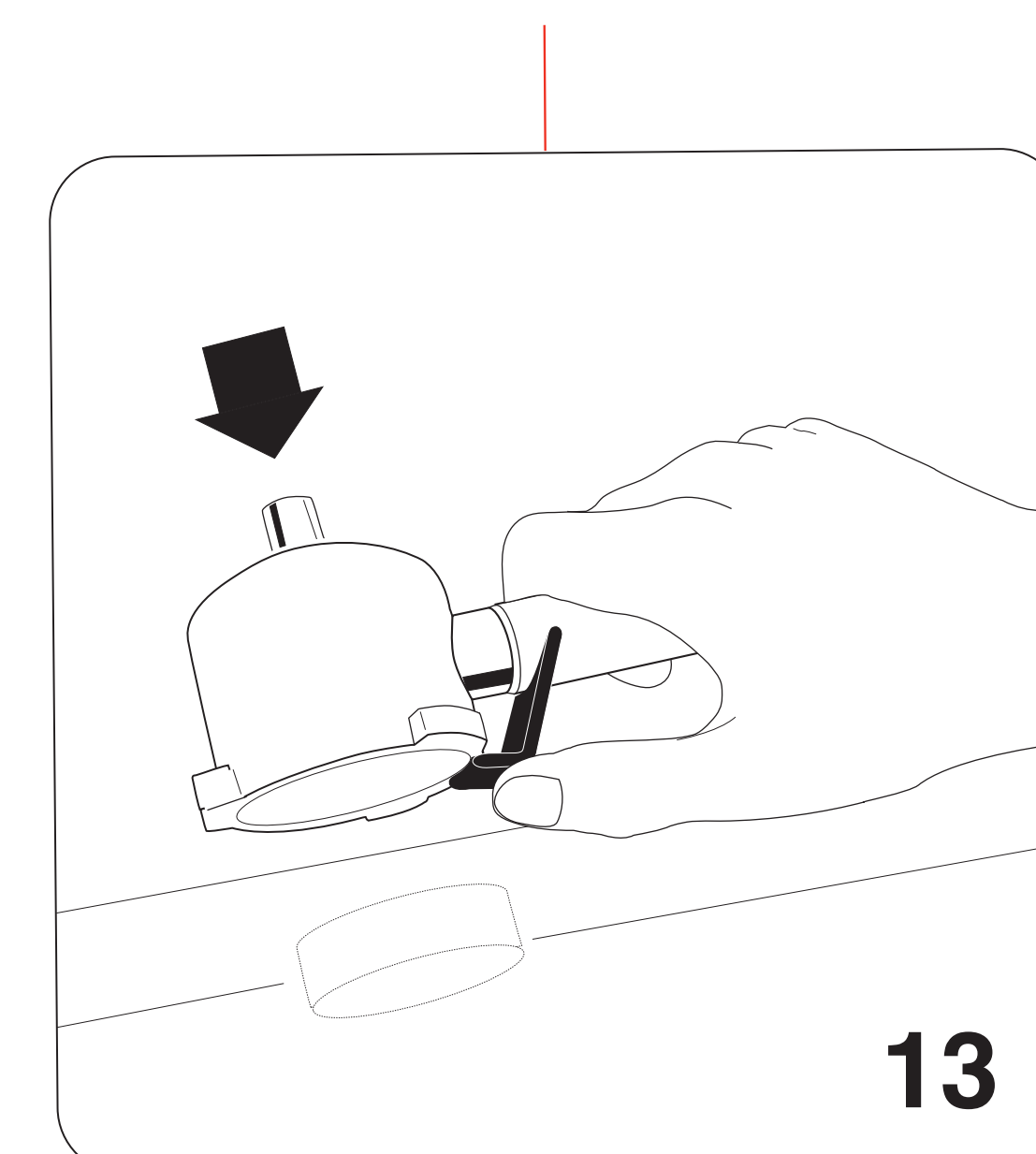

13